

INTERIM HERITAGE PLACES REGISTER

CITATION

Name of Place: AINSLIE PUBLIC AND PRIMARY SCHOOLS, BRADDON

LOCATION OF PLACE:

Section and Block Suburb: Block 1 Section 31 Braddon

Area bounded by: Bounded by Donaldson Street, Elouera Street, Elder Street and Limestone Avenue, including verges

FEATURES INTRINSIC TO THE HERITAGE SIGNIFICANCE OF THE PLACE:

The features intrinsic to the heritage significance of the place are:

- Ainslie Primary School Building and former shelter sheds
- the former Ainslie Public School Building and former lavatory
- original internal fittings; and
- associated landscape.

The establishment of the Ainslie Schools played a pivotal role in the development of the community to the north of Civic Centre. The site has a high degree of integrity with intact street and site planting, continuity of educational use and relatively intact built elements and original internal fittings.

The site exemplifies community schools in the garden city ideals of WB Griffin, John Sulman and the FCAC/FCC as interpreted by horticulturist, TCG Weston, and the Federal Capital/Art Deco stylists of the late 1920s and 1930s; including JS Murdoch, RM Rolland, C Whitley and EH Henderson. The Public School (1927) was opened by Prime Minister Rt Hon SM Bruce.

The Ainslie Schools' site has a high potential for cultural interpretation. It is part of a heritage precinct which evidences the application of garden city principles, formal planning for the nation's capital and the social history of early Canberra.

The original internal layout evidences Public School philosophy of the time, in particular with regard to segregation of the sexes and class size. The Primary School is believed to be the first in Australia to be planned with a library, tiered lecture room seating and a needlework room.

STATEMENT OF SIGNIFICANCE:

This building together with its companion infants school facing Doonkuna Street forms an excellent example of buildings perhaps unique in style to Canberra. The mature trees and well maintained grounds contribute to the importance of this group. These two schools are a significant part of the grouping termed "Federation Canberra". The façade facing Donaldson Street, the entry Foyer and the library are of particular significance.

SPECIFIC REQUIREMENTS:

In accordance with s.54(1) of the Land (Planning and Environment) Act 1991, the following requirements are identified as essential to the conservation of the heritage significance of this place. These requirements are prepared to implement the following conservation policy for the place:

The school buildings, shelter sheds, former lavatory original internal fittings and grounds are to be conserved and appropriately maintained consistent with their heritage significance.

Any action affecting the requirements to conserve the heritage significance of this place is development under Part VI of the Land Act and requires approval prior to undertaking the activity. To undertake development without prior approval may constitute an offence.

1. Requirements Relating to the Building

- 1.1 Alterations and additions, including alterations to finishes (such as painting and adding or removing wall claddings), must reflect and complement the architectural style of the original structure.
- 1.2 Demolition shall not be permitted, other than in exceptional circumstances, including circumstances in which the structures are structurally unsound and beyond economic repair or where there are significant public health and safety reasons to warrant demolition. All prudent and feasible alternatives to demolition will need to have been explored before demolition is considered. The demolition of original building fabric shall only be allowed in the context of sympathetic alteration and additions.

2. Requirements Relating to the Setting

- 2.1 The established landscape character of the place shall be retained.
- 2.2 Construction of new landscape elements in the place shall only be permitted where it can be demonstrated to the satisfaction of the Heritage Council, that the new elements do not adversely affect the landscape setting of the place.
- 2.3 All mature landscape elements are to be conserved and appropriately maintained, including the street tree planting; English Oak (*Quercus robur*) and Nettle Trees (*Celtis occidentalis*), and original hedges; Japanese Spindle tree (*Evonymus japonica Aureo variegata*) and Firethorn (*Pyracantha angustifolia*).
- 2.4 The original symmetrical layout, including tennis courts, playing fields and circulation routes centred on the main axis is to be retained

3. Requirements Relating to Original Fittings

- 3.1 All original fittings including stylized Art Deco lettering, grills, chevron vents, cornices, architraves, doors, parqueted floors, brass handrails, light fittings, cornices, doors, furniture, tiles, blackboards, bubblers, furniture made for the building and bronze doors at the main entry, shall be retained.

MANAGEMENT RECOMMENDATIONS:

In assessing this place for the interim Heritage Places Register, the Council recommends that the following actions and activities should be undertaken which will enhance the heritage values of the place. They are made as recommendations and have no legal effect:

1. that detailed conservation and management planning policies be prepared, in consultation with the ACT Heritage Council. It is recommended that these planning policies be consistent with the Conservation and Management Plan prepared in 1986/87 by Dowling Freeman Pty Ltd. These policies should be updated periodically to retain their relevance.

DOCUMENT HISTORY

1. 31/1/96 Preliminary draft citation considered by ACT Heritage Council at Meeting 36

2. 28/2/97 Draft citation released for public comment
3. date Revised citation for ACT Heritage Council Meeting (number)
4. date Gazetted in an interim Heritage Places Register

This version 24/10/97

6. REFERENCES:

Author Title date publication

1.

BACKGROUND INFORMATION

DESCRIPTION OF PLACE:

WAINSLIE PUBLIC AND PRIMARY SCHOOLS, BRADDON.

The building is two storied rendered brick symmetrical about an axis along Gooreen Street. The stepped façade and the interior have simple "Art Deco" decorative elements such as vents, grills, cornices and light fittings. The interior finishes are all good quality, with original parquetry, tiling and brass hand-rails still intact. The front doors are bronze. The building is naturally ventilated and centrally heated.

STATUS OF PLACE AT NOMINATION DATE:

Classified 30/3/81

BACKGROUND:

RELEVANT PRINCIPAL NATIONAL HISTORIC THEMES:

ANALYSIS AGAINST THE CRITERIA SPECIFIED IN SCHEDULE 2 OF THE LAND (PLANNING AND ENVIRONMENT) ACT 1991

Section 56 the criteria for the assessment of the heritage significance of places are:

- (i) a place which demonstrates a high degree of technical and/or creative achievement, by showing qualities of innovation or departure, or representing a new achievement of its time;
- (ii): a place which exhibits outstanding design or aesthetic qualities valued by the community or a cultural group;
- (iii) a place which demonstrates a distinctive way of life, taste, tradition, religion, land use, custom, process, design or function which is no longer practised, is in danger of being lost, or is of exceptional interest;
- (iv): a place which is highly valued by the community or a cultural group for reasons of strong or special religious, spiritual, cultural, educational or social associations;
- (v) a place which is the only known or only comparatively intact example of its type;
- (vi) a place which is a notable example of a class of natural or cultural places or landscapes and which demonstrates the principal characteristics of that class;
- (vii) a place which has strong or special associations with a person, group, event, development or cultural phase which played a significant part in local or national history;
- (viii) a place which represents the evolution of a natural landscape, including significant geological features, landforms, biota or natural processes;
- (ix) a place which is a significant habitat or locality for the life cycle of native species; for rare, endangered or uncommon species; for species at the limits of their natural range; or for district occurrences of species;
- (x) a place which exhibits unusual richness, diversity or significant transitions of flora, fauna or natural landscapes and their elements; or
- (xi) a place which demonstrates a likelihood of providing information which will contribute significantly to a wider understanding of natural or cultural history, by virtue of its use as a research site, teaching site, type locality or benchmark site.

(Town or District) Ainslie

AINSLIE PRIMARY SCHOOL

Donaldson Street,
Braddon, A.C.T.
2601.

Post Code 2601
Local Govt Area

Author of Ms. M. McDougall
Proposal

Date of Proposal 10.3.81

(Name or Identification of Listing)

(Address or Location)

Suggested Listing Category Classify

Bibliography

Owner and Address

Committee (Trust Use)

Paper by Ms. M. McDougall

D.C.T.

Council Classified (Trust Use) 30.3.81

NEA. 1983.

Description

Briefly cover the points on the following check list where they are relevant and within your knowledge.

Style
Construction
Use
Architect/s
Builder/s
Date of Construction
Present Condition
History
Owners
Boundaries of proposed listing

Designed in 1936 and opened 17 September 1938, as a primary school, this building is now the Ainslie Public School; housing both infants and primary. The Building cost £34754 and was the first government primary school in Australia to incorporate in its initial plan, a lecture room and needlework room. The building is 2 storied rendered brick, symmetrical about an axis along Goreen Street. The stepped facade and the interior have simple "art deco" style decorative elements such as vents, grills cornices and light fittings. The interior finishes are all good quality, with original parquetry, tiling and brass handrails still intact. The front doors are bronze. Recent renovations have detracted from the first floor and rear, but the facade, entry foyer and library are still basically intact. The building is naturally ventilated and centrally heated.

Reasons for listing

Together this and its companion infants school facing Doonkuna Street form an excellent example of buildings perhaps unique in style to Canberra. The mature trees and well maintained grounds contribute to the importance of this group. These schools form part of the grouping termed "Federation Canberra".

National Trust of Australia (N.S.W.) Listing Proposal NTN.05

Sk
A1
if

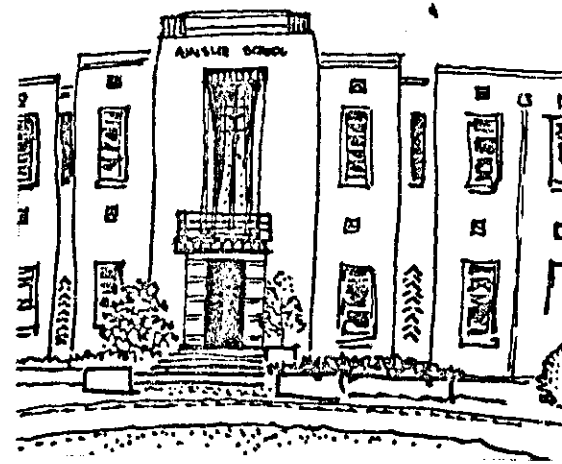
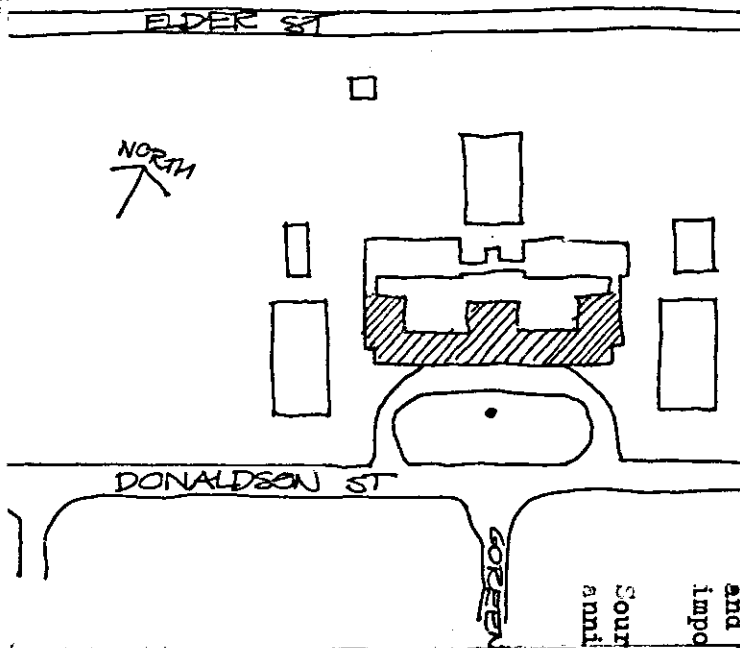

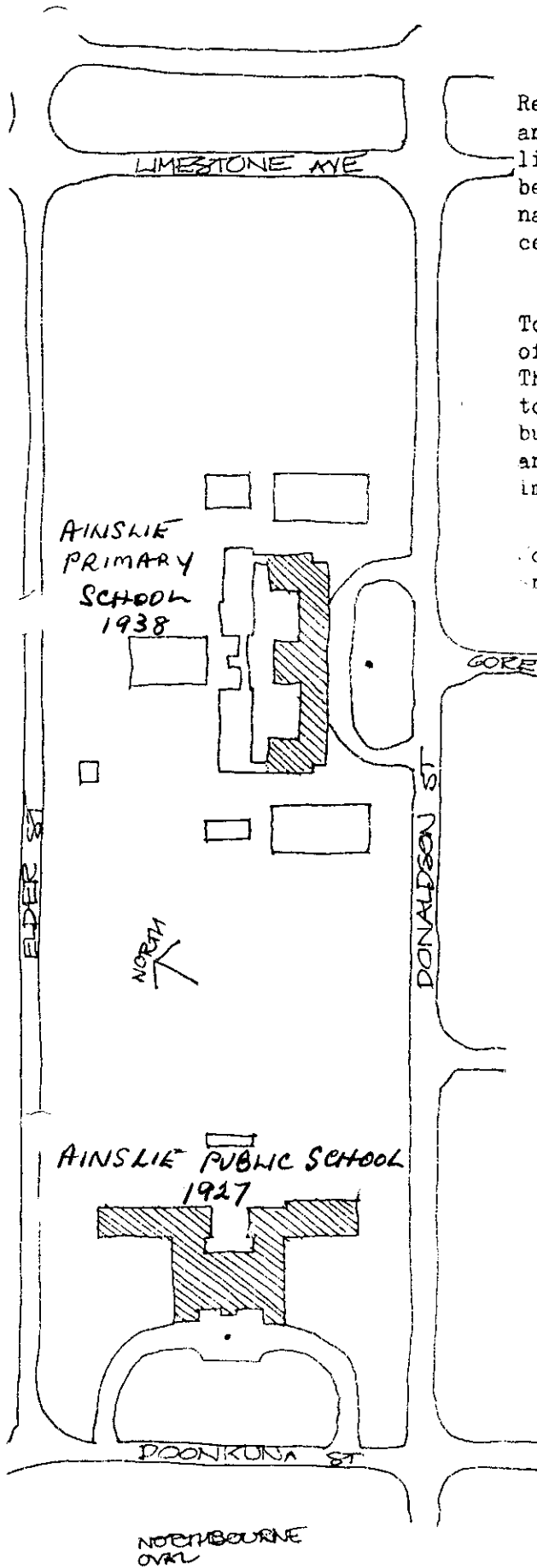

Recent renovations have spoilt the first floor and rear, but the facade, the entry foyer and library are still basically intact (library has been extended at one end). The building is naturally ventilated (and works well), and is centrally heated.

Together, the schools form an excellent example of buildings perhaps unique to Canberra (in style). The symmetry, and the setting are elements common to other early Canberra public buildings. The buildings are intact, and the mature trees and well maintained grounds contribute to the importance of the group.

Source : A booklet produced for the 50th anniversary of the school giving the history.