



# Tranquil Waters

BEACHFRONT RETIREMENT

## Villa 39 - The Endeavour 3

- Two Bedrooms & Study • Lockup Garage
  - Ensuite & Bathroom • Independent Living Villa
- Floor Area 168.323m<sup>2</sup> (18.12sq)

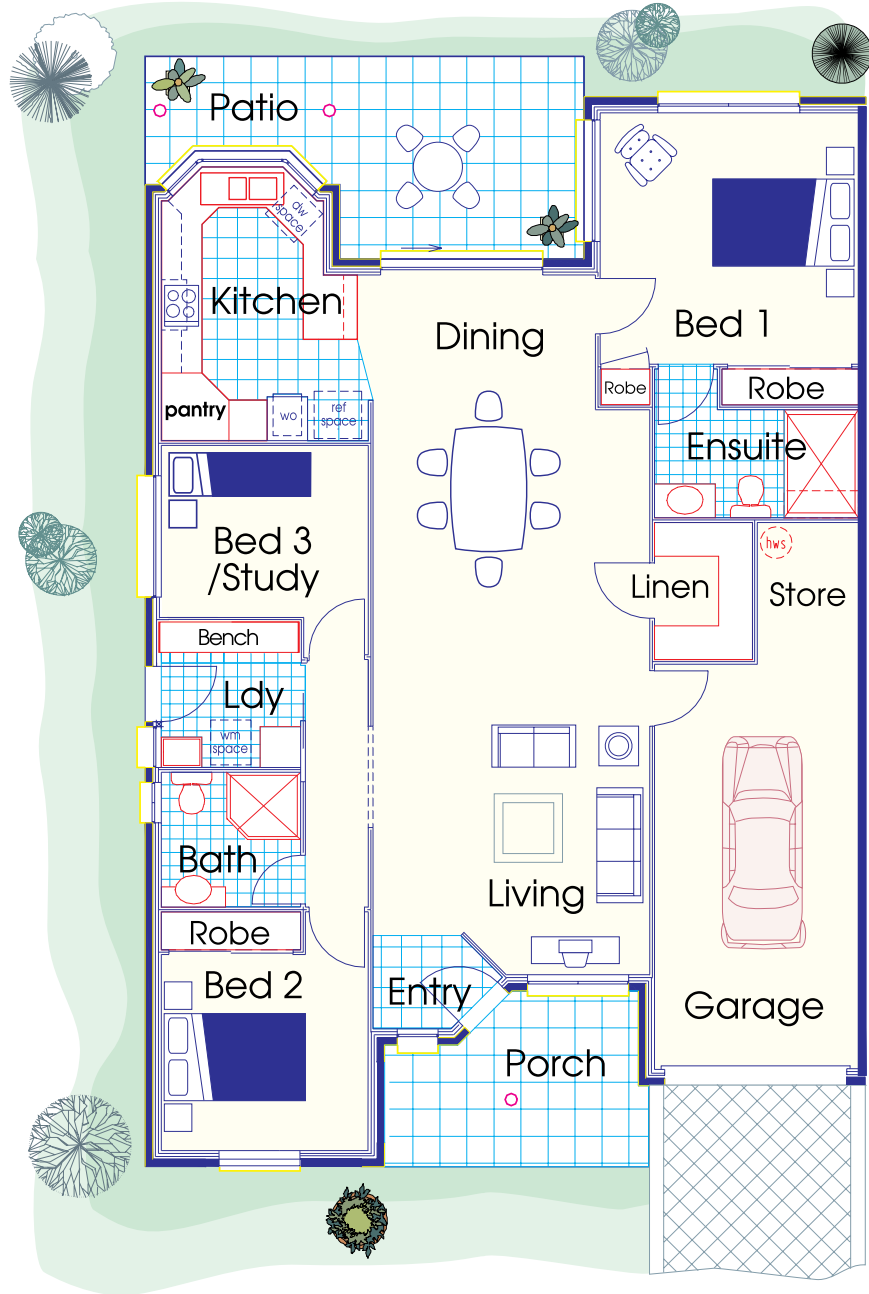

### Floor Plan Room Sizes

BED 1	3720*3825	12'2" * 12'5"	PORCH	2300*3760	7'5" * 12'3"
BED 2	2900*3065	9'5" * 10'	KITCHEN	4050*3065	13'3" * 10'1"
PATIO	3000*6500	9'8" * 21'3"	LAUNDRY	2000*2065	6'6" * 6'8"
DINING	4260*4100	13'9" * 13'4"	BATHROOM	2000*2065	6'6" * 6'8"
LIVING	6100*4100	20' * 13'5"	STUDY/BED 3	2700*3065	8'9" * 10'
GARAGE	6000*3020	19'6" * 9'9"	LINEN	2100*1450	6'9" * 4'8"
ENTRY	1300*1300	4'3" * 4'3"	ENSUITE	1600*3020	5'2" * 9'9"
STORE	2100*1500	6'9" * 4'9"			

# Villa 39 - The Endeavour 3

- Two Bedrooms & Study • Lockup Garage
  - Ensuite & Bathroom • Independent Living Villa
- Floor Area 168.323m<sup>2</sup> (18.12sq)

## Bedroom 1

- Variable speed ceiling fan
- Built-in robe, shelves, hanging rods
- Quality carpet
- Telephone point
- TV point and power point
- Wall mounted mirror fitted in cabinet / robe

## Ensuite

- Shower with flexible hand set
- Vanity unit and basin
- Wall mounted mirror
- Wall mounted cabinet
- Powder coated shower screen and laminated glass
- Quality mixer taps
- Exhaust fan and heater light
- Ceramic wall and floor tiles to wet areas
- WC & Support rails

## Bedroom 2

- Variable speed ceiling fan
- Built-in robe
- Shelves and hanging rods
- Quality carpet
- Power points

## Bathroom

- Vanity unit and basin
- Shower with flexible hand set
- Powder coated shower screen and laminated glass
- Ceramic wall and floor tiles to wet areas
- Wall mounted mirror
- Quality mixer taps
- Exhaust fan and heater light
- WC & Support rails

## Living / Dining

- Variable speed ceiling fan
- Quality carpet (Villa 35 tiled)
- Linen cupboards
- Telephone point
- Television point
- Feature cornice

## Study

- Quality carpets
- Ceiling fan

## Kitchen

- Stainless steel one and half bowl sink with quality mixer tap
- Built-in cupboards
- Pantry cupboard, many drawers
- Dishwasher drawer
- Quality wall oven and hot plates
- Quality floor tiles
- Down light over sink area
- Exhaust fan

## Garage

- Lock up panel lift door with remote control and internal access
- Light
- Varie-coat flooring

## Patio and Porch

- Entrance porch / paved / tiled
- Tiles to patio
- Ceiling light fitted to patio and porch
- Weatherproof power point

## Laundry

- Stainless steel wash tub
- Bench and cupboards

## Site Landscaping

- Intensive landscaping
- Automatic irrigation
- Fold-down clothes line
- Hose tap

## General Items

- High ceilings
- VAC maid plumbed
- All walls and ceilings in quality paint
- All ceilings finished in quality finish paint
- Sliding powder coated aluminium windows
- Doors, architraves and skirting with gloss enamel paint finish
- Hot water system
- All windows fitted with key locks
- Quality internal doors
- Feature front door
- Smoke detector - mains & battery back-up
- Wired and plumbed for air conditioning
- Emergency call system

## Store / Linen